



Ware Street

Bearsted, Maidstone ME14 4PG

- Charming Victorian Cottage
- Walking Distance To Bearsted Station
- Country Style Fitted Kitchen
- Off Street Parking For Two Cars
- Superb Location Close To Bearsted Green
- Reception Room With Log Burning Stove

Asking Price £300,000 Freehold



Local Authority
Council Tax Band C
EPC Rating C

Ware Street, Bearsted, Maidstone, ME14

Approximate Area = 588 sq ft / 54.6 sq m

For identification only - Not to scale

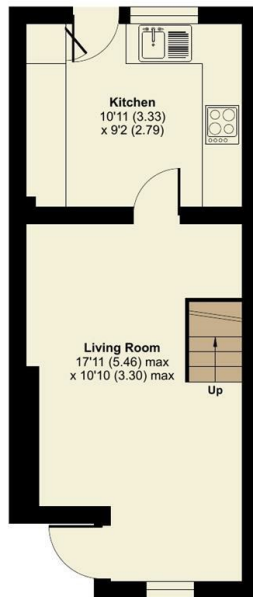

GROUND FLOOR



FIRST FLOOR

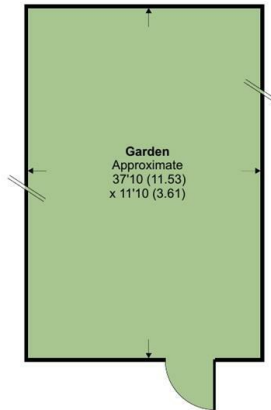

Floor plan produced in accordance with RICS Property Measurement Standards incorporating International Property Measurement Standards (IPMS2 Residential). © nichecom 2023. Produced for Simon Miller & Company. REF: 974220

Maidstone & The Weald Office

11 Colman House, Colman Parade, King
Street, Maidstone, Kent, ME14 1DJ

Contact

01622 691255
maidstonesales@simonmiller.co.uk

Agents Note: Whilst every care has been taken to prepare these particulars, they are for guidance purposes only. All measurements are approximate and for general guidance purposes only and whilst every care has been taken to ensure accuracy, they should not be relied upon and potential buyers/tenants are advised to recheck the measurements.

