



Saltings Road , Snodland ME6 5HA

- Three Bedroom Terraced Family Home
- SOUTH FACING Rear Garden
- Seperate W/C
- 17Ft Living Room
- Garage And Off Road Parking
- Kitchen / Diner

Asking Price £300,000 Freehold



Local Authority
Council Tax Band C
EPC Rating C

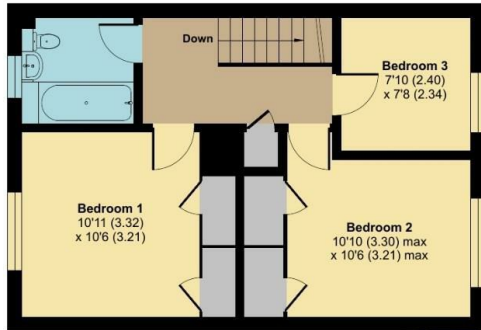

FIRST FLOOR

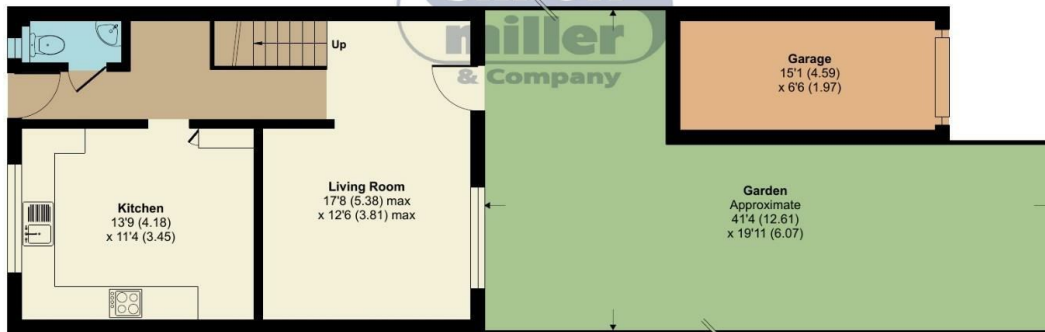

GROUND FLOOR



Floor plan produced in accordance with RICS Property Measurement Standards incorporating International Property Measurement Standards (IPMS2 Residential). © richeckom 2024. Produced for Simon Miller & Company. REF: 1107401

Saltings Road, Snodland, ME6

Approximate Area = 934 sq ft / 86.7 sq m
Garage = 97 sq ft / 9 sq m
Total = 1031 sq ft / 95.7 sq m
For identification only - Not to scale



Malling Office

777 London Road, Larkfield, Aylesford,
Kent, ME20 6DE

Contact

01732 875706
larkfieldsales@simonmiller.co.uk
<https://simonmiller.co.uk/>

Agents Note: Whilst every care has been taken to prepare these particulars, they are for guidance purposes only. All measurements are approximate and for general guidance purposes only and whilst every care has been taken to ensure accuracy, they should not be relied upon and potential buyers/tenants are advised to recheck the measurements.