



Pear Tree Avenue

Ditton, Aylesford ME20 6EB

- Fantastic Corner Plot Three Bedroom Semi Detached Home
- Bright And Airy Through Lounge/ Diner
- Within Close Proximity Of Schools And Amenities
- Two Double Bedrooms
- Ready To View NOW
- Positioned Down A Private Walkway

Offers In Excess Of £375,000 Freehold



Local Authority
Council Tax Band D
EPC Rating D

Pear Tree Avenue, Ditton, Aylesford, ME20

Approximate Area = 878 sq ft / 81.5 sq m

For identification only - Not to scale



GROUND FLOOR

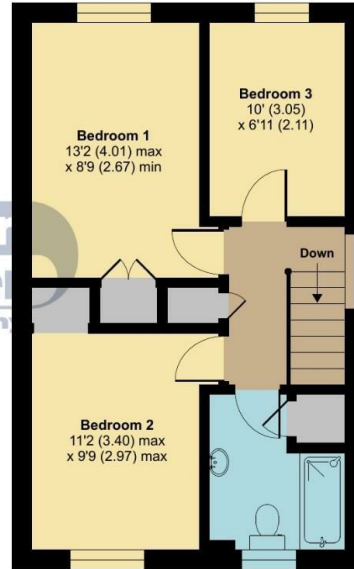

FIRST FLOOR



Floor plan produced in accordance with RICS Property Measurement Standards incorporating International Property Measurement Standards (IPMS2 Residential). © nichecom 2024. Produced for Simon Miller & Company. REF: 1109535



Malling Office
777 London Road, Larkfield, Aylesford,
Kent, ME20 6DE

Contact
01732 875706
larkfieldsales@simonmiller.co.uk
<https://simonmiller.co.uk/>

Agents Note: Whilst every care has been taken to prepare these particulars, they are for guidance purposes only. All measurements are approximate and for general guidance purposes only and whilst every care has been taken to ensure accuracy, they should not be relied upon and potential buyers/tenants are advised to recheck the measurements.