



Kent Street

Mereworth, Maidstone ME18 5QW

- A Converted and updated Former Chapel
- Fitted Kitchen and Utility area
- Garage and Parking
- Adjacent to local Farmland
- Vacant Possession
- Key Accompanied Viewings Available

Offers In Excess Of £425,000 Freehold

Local Authority
Council Tax Band F
EPC Rating E



Kent Street, Mereworth, Maidstone, ME18

Approximate Area = 1758 sq ft / 163.3 sq m
Limited Use Area = 18 sq ft / 1.7 sq m
Total = 1776 sq ft / 165 sq m

For identification only - Not to scale

Denotes restricted
head height



FIRST FLOOR

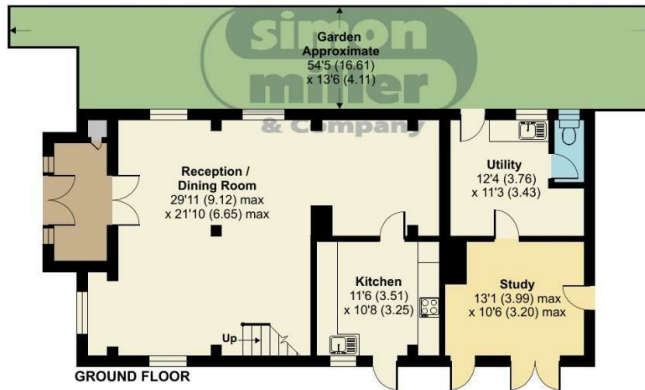

GROUND FLOOR



Floor plan produced in accordance with RICS Property Measurement Standards incorporating International Property Measurement Standards (IPMS2 Residential). © nichecom 2023. Produced for Simon Miller & Company. REF: 1001390



Mailing Office

777 London Road, Larkfield, Aylesford,
Kent, ME20 6DE

Contact

01732 875706
larkfieldsales@simonmiller.co.uk
<https://simonmiller.co.uk/>

Agents Note: Whilst every care has been taken to prepare these particulars, they are for guidance purposes only. All measurements are approximate and for general guidance purposes only and whilst every care has been taken to ensure accuracy, they should not be relied upon and potential buyers/tenants are advised to recheck the measurements.