



## Little Market Row

Leybourne, West Malling ME19 5QL

- Popular 'Leybourne Village' Location
  - Low Maintenance
  - Open Plan Layout
- One Allocated Parking Space
  - Local Amenities
  - Ideal First Time Buy

**Offers In Excess Of £175,000 Leasehold**

Local Authority Tonbridge and  
Malling Borough Council  
Council Tax Band B  
EPC Rating C

## Little Market Row, Leybourne, West Malling, ME19

APPROX. GROSS INTERNAL FLOOR AREA 487 SQ FT 45.2 SQ METRES

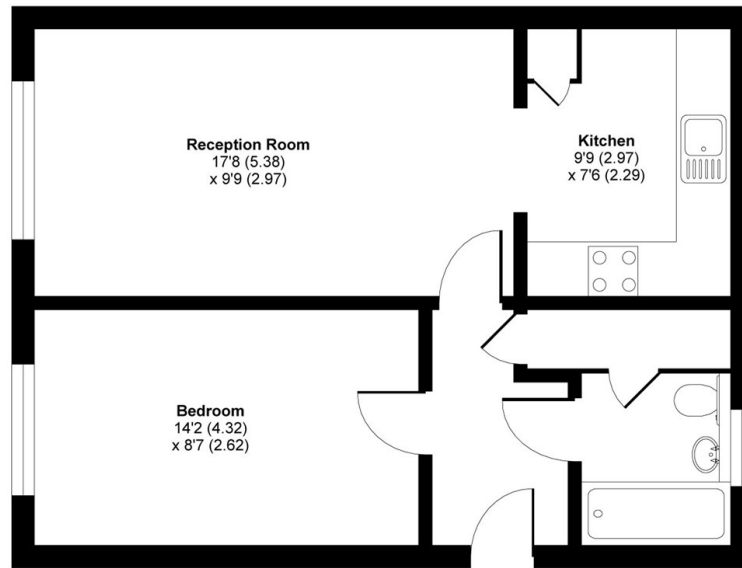

FIRST FLOOR

Whilst every attempt has been made to ensure the accuracy of the floor plan contained here, measurements of doors, windows and rooms are approximate and no responsibility is taken for any error, omission or misstatement. These plans are for representation purposes only as defined by RICS Code of Measuring Practice and should be used as such by any prospective purchaser. Specifically no guarantee is given on the total square footage of the property if quoted on this plan. Any figure given is for initial guidance only and should not be relied on as a basis of valuation.

Copyright nichecom.co.uk 2017 Produced for Simon Miller & Company REF : 202914



### Malling Office

777 London Road, Larkfield, Aylesford,  
Kent, ME20 6DE

### Contact

01732 875706  
larkfieldsales@simonmiller.co.uk  
<https://simonmiller.co.uk/>

Agents Note: Whilst every care has been taken to prepare these particulars, they are for guidance purposes only. All measurements are approximate and for general guidance purposes only and whilst every care has been taken to ensure accuracy, they should not be relied upon and potential buyers/tenants are advised to recheck the measurements.