



Barleycorn

Leybourne, West Malling ME19 5PS

- GUIDE PRICE £300,000 - £320,000
- Two Allocated Parking Spaces
- Recently Fitted UPVC Double Glazing
- Chain Free!!!
- Modern Fitted Bathroom
- West Facing Rear Garden

Price Guide £300,000 Freehold

Local Authority
Council Tax Band C
EPC Rating C

Barleycorn, Leybourne, West Malling, ME19

Approximate Area = 612 sq ft / 56.8 sq m
For identification only - Not to scale

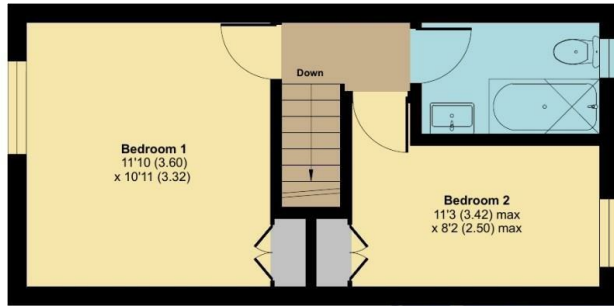

FIRST FLOOR

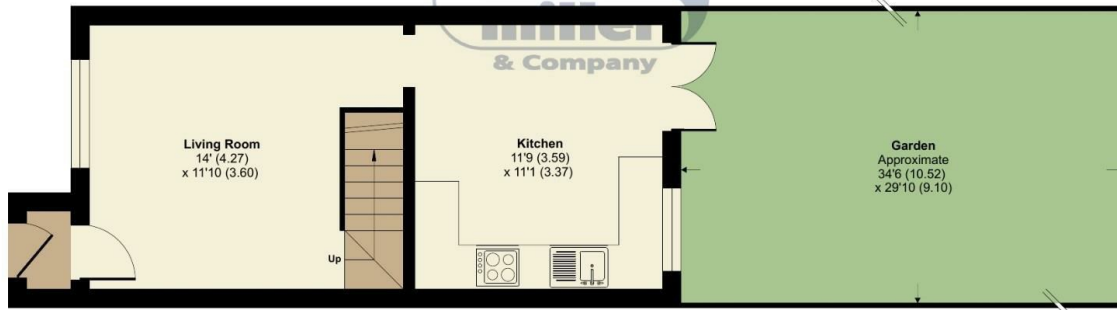

GROUND FLOOR

Floor plan produced in accordance with RICS Property Measurement 2nd Edition, Incorporating International Property Measurement Standards (IPMS2 Residential). © n3cheom 2024. Produced for Simon Miller & Company. REF: 1219930



Malling Office
777 London Road, Larkfield, Aylesford,
Kent, ME20 6DE

Contact
01732 875706
larkfieldsales@simonmiller.co.uk
<https://simonmiller.co.uk/>

Agents Note: Whilst every care has been taken to prepare these particulars, they are for guidance purposes only. All measurements are approximate and for general guidance purposes only and whilst every care has been taken to ensure accuracy, they should not be relied upon and potential buyers/tenants are advised to recheck the measurements.