



Lettings



Ashford Road

, Maidstone ME14 5BH

- Grade II Listed Building
- Town Centre Location
- Allocated Parking
- One/two Split Level Bedroom
- Fully Equipped Kitchen
- Available NOW!!!

£1,100 PCM



Local Authority Maidstone
Borough Council
Council Tax Band B
EPC Rating E

Ashford Road, Maidstone, ME14

Approximate Area = 640 sq ft / 59.4 sq m
For identification only - Not to scale

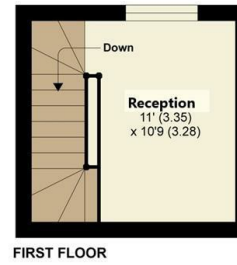

Floor plan produced in accordance with RICS Property Measurement Standards incorporating International Property Measurement Standards (IPMS2 Residential). © richecom 2021. Produced for Simon Miller & Company. REF: 719118

Lettings Office

Lettings Division, 779 London Road,
Larkfield, Aylesford, Kent, ME20 6DE

Contact

01732 875777
lettings@simonmiller.co.uk
<https://simonmiller.co.uk/landlo/services/>

Agents Note: Whilst every care has been taken to prepare these particulars, they are for guidance purposes only. All measurements are approximate and for general guidance purposes only and whilst every care has been taken to ensure accuracy, they should not be relied upon and potential buyers/tenants are advised to recheck the measurements.