

PERIOD HOMES

By Simon Miller



Police Station Road

, West Malling ME19 6LL

- GUIDE PRICE: £500,000-£525,000
- Three Bedrooms Appointed Over Three Levels
- Walking Distance to the High Street and Train Station
- A Wonderful Period Property
- Refurbished and Upgraded Interior
- MUST VIEW INTERNALLY

Guide Price £500,000 Freehold



Local Authority
Council Tax Band D
EPC Rating

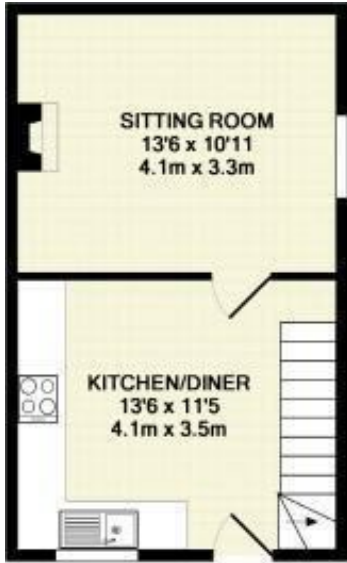

GROUND FLOOR
APPROX. FLOOR
AREA 301 SQ.FT.
(27.9 SQ.M.)

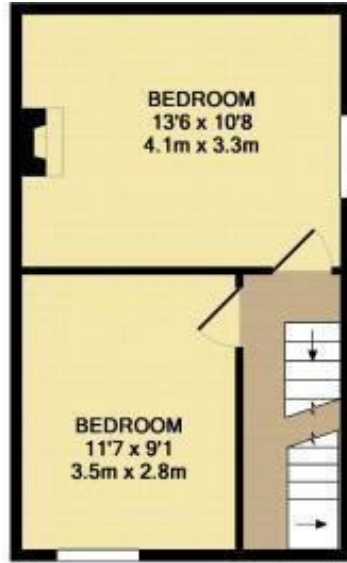

1ST FLOOR
APPROX. FLOOR
AREA 301 SQ.FT.
(27.9 SQ.M.)



2ND FLOOR
APPROX. FLOOR
AREA 301 SQ.FT.
(27.9 SQ.M.)

TOTAL APPROX. FLOOR AREA 903 SQ.FT. (83.8 SQ.M.)

Whilst every attempt has been made to ensure the accuracy of the floor plan contained here, measurements of doors, windows, rooms and any other items are approximate and no responsibility is taken for any error, omission, or mis-statement. This plan is for illustrative purposes only and should be used as such by any prospective purchaser. The services, systems and appliances shown have not been tested and no guarantee as to their operability or efficiency can be given
Red Hot Camera ©2012



Period Homes by Simon Miller Office
Weald, 5 High Street, Headcorn, Ashford,
Kent, TN27 9NH

Contact

01622 850888
admin@periodhomesbysimonmiller.co.uk
<https://simonmiller.co.uk/period-homes/>

Agents Note: Whilst every care has been taken to prepare these particulars, they are for guidance purposes only. All measurements are approximate and for general guidance purposes only and whilst every care has been taken to ensure accuracy, they should not be relied upon and potential buyers/tenants are advised to recheck the measurements.