

Floor plan produced in accordance with RICS Property Measurement Standards incorporating International Property Measurement Standards (IPMS2 Residential). © nchecom 2022. Produced for Simon Miller & Company. REF: 899193

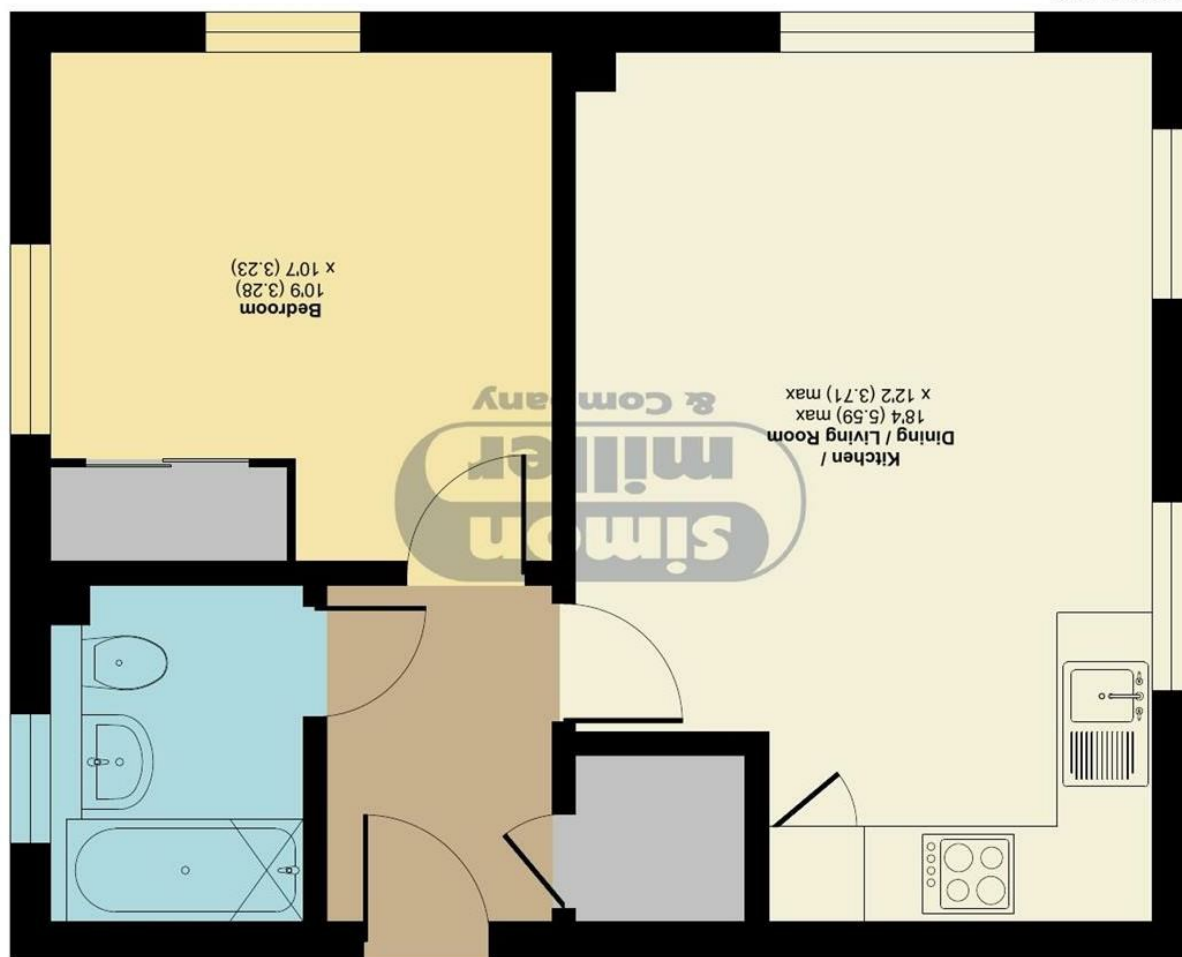

THIRD FLOOR



Approximate Area = 426 sq ft / 40 sq m
For identification only - Not to scale

Church Street, Maidstone, ME14

Guide Price £170,000
EPC RATING: C

Goring Place Church Street, Maidstone, ME14 1FJ



simon
miller
& Company



A fantastic opportunity to purchase a spacious and well presented one-bedroom top floor apartment situated in the heart of Maidstone town centre. The apartment has been cleverly designed to optimise space and features a contemporary style specification. Accommodation comprises lounge incorporating kitchen, spacious bedroom, bathroom. Double glazing and electric central heating via radiators.

MATERIAL INFORMATION

Leasehold - Share of Freehold
Council Tax Band C
EPC Report C



• GUIDE PRICE £170,000 - £180,000 • Chain Free • Top Floor Apartment • Spacious Bedroom • Lounge/Kitchen • Bathroom • Electric Heating • Contemporary Specification

Agents Note: All dimensions are approximate and quoted for guidance only. Reference to appliances, fixtures, fittings and services does not imply that they are necessarily in good condition, fit the purpose or are in working order. Interested parties are advised to obtain verification from their Solicitors as to the Freehold/Leasehold status of the property and confirmation regarding the condition of any fixtures and fittings included in the sale.

11, COLMAN HOUSE, MAIDSTONE, KENT, ME14 1DJ | 01622 691255 | MAIDSTONESALES@SIMONMILLER.CO.UK