



## Knights Way

, Headcorn TN27 9TX

- Ground Floor Maisonette
  - 14' Lounge
  - 3 Piece Bathroom
- Village Cul-de-sac Location
- Available Beginning of February
- Two Double Bedrooms
  - Fitted Kitchen
  - Gas Central Heating
  - Own Private Garden

**£1,100 PCM**

Local Authority Maidstone  
Borough Council  
Council Tax Band B  
EPC Rating C

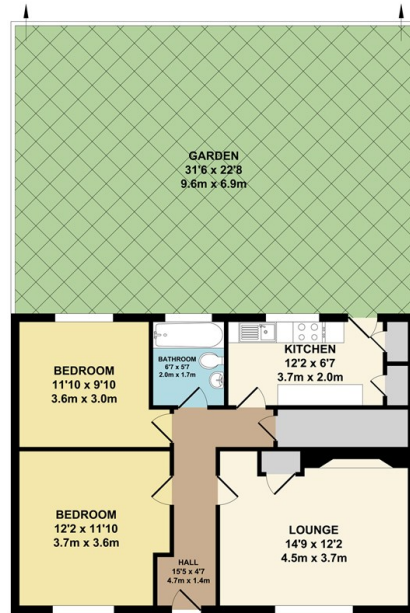

APPROX. FLOOR AREA  
681 SQ.FT.  
(63.24 SQ.M.)

TOTAL APPROX. FLOOR AREA 681 SQ.FT. (63.24 SQ.M.)  
Whilst every attempt has been made to ensure the accuracy of the floor plan contained herein, measurements of doors, windows, rooms and any other items are approximate and no responsibility is taken for any error, omission or mis-statement. This plan is for illustrative purposes only and should be used as such by any prospective purchaser. The services, systems and appliances shown have not been tested and no guarantee as to their operability or efficiency can be given  
Red Hot Camera 12/2/15

### Lettings Office

Lettings Division, 779 London Road,  
Larkfield, Aylesford, Kent, ME20 6DE

### Contact

01732 875777  
lettings@simonmiller.co.uk  
<https://simonmiller.co.uk/landlo/services/>

Agents Note: Whilst every care has been taken to prepare these particulars, they are for guidance purposes only. All measurements are approximate and for general guidance purposes only and whilst every care has been taken to ensure accuracy, they should not be relied upon and potential buyers/tenants are advised to recheck the measurements.

