



## The Street

Boxley, Maidstone ME14 3DX

- Stunning period property full of character and charm
- Blends historic character with comfortable modern living
  - Luxurious Kitchen and Breakfast Room
- Rare opportunity to make this property your home
- Sought-after village location in the heart of Boxley
  - Four Bedrooms and Three Utility Rooms
- Beautiful outside space and gardens
  - Available End of February 2026

**£3,000 Per Calendar Month**





Local Authority Maidstone  
Borough Council  
Council Tax Band G  
EPC Rating D

## The Granary, Court Lodge Farm, The Street, Boxley, Maidstone, ME14

APPROX. GROSS INTERNAL FLOOR AREA 2528 SQ FT 234.9 SQ METRES (EXCLUDES VOID)

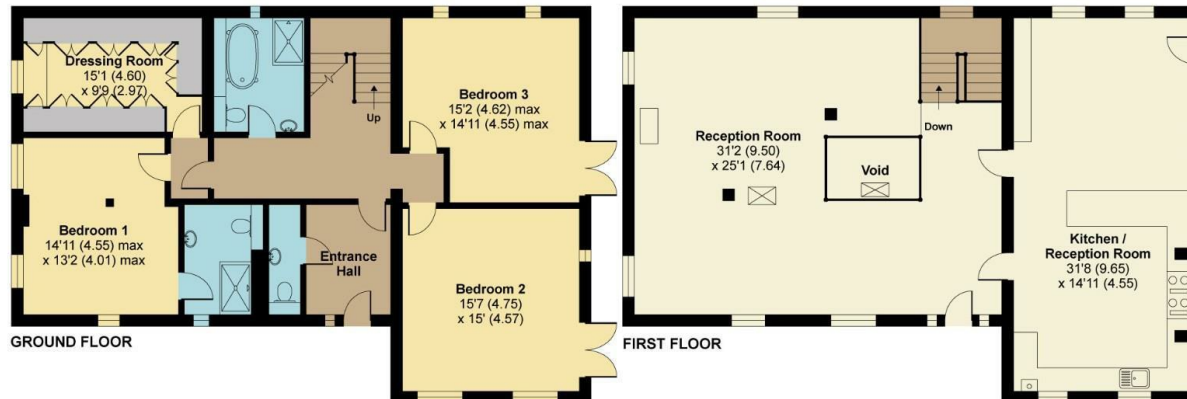

Whilst every attempt has been made to ensure the accuracy of the floor plan contained here, measurements of doors, windows and rooms are approximate and no responsibility is taken for any error, omission or misstatement. These plans are for representation purposes only as defined by RICS Code of Measuring Practice and should be used as such by any prospective purchaser. Specifically no guarantee is given on the total square footage of the property if quoted on this plan. Any figure given is for initial guidance only and should not be relied on as a basis of valuation.  
Copyright nichecom.co.uk 2019 Produced for Simon Miller & Company REF : 483671

### Lettings Office

Lettings Division, 779 London Road,  
Larkfield, Aylesford, Kent, ME20 6DE

### Contact

01732 875777  
lettings@simonmiller.co.uk  
<https://simonmiller.co.uk/landlo-services/>

Agents Note: Whilst every care has been taken to prepare these particulars, they are for guidance purposes only. All measurements are approximate and for general guidance purposes only and whilst every care has been taken to ensure accuracy, they should not be relied upon and potential buyers/tenants are advised to recheck the measurements.

