

PERIOD HOMES

By Simon Miller



Kenward Road

, Yalding ME18 6JR

- GUIDE PRICE: £525,000 - £550,000
- Three Bedrooms - Two Receptions - Two Bath/ Shower Rooms
- Pretty Garden, Driveway and Large Shed/Storage
- Charming Upgraded and Improved Period Cottage
- Open Plan Kitchen/ Oak Framed Conservatory
- Popular Kentish Village

Guide Price £525,000 Freehold

Local Authority
Council Tax Band F
EPC Rating C

Honeysuckle Cottage Kenward Road, Yalding, Maidstone, Kent
Approximate Gross Internal Area
Main House = 1177 Sq Ft/109 Sq M
Outbuilding = 66 Sq Ft/6 Sq M
Total = 1243 Sq Ft/115 Sq M

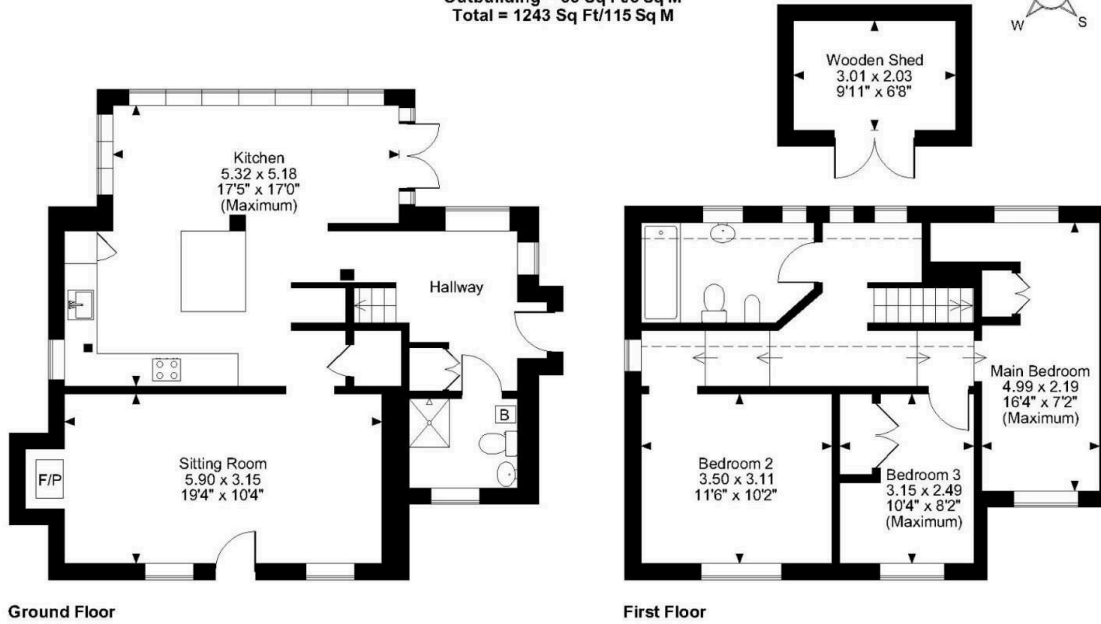

Ground Floor

First Floor

FOR ILLUSTRATIVE PURPOSES ONLY - NOT TO SCALE

The position & size of doors, windows, appliances and other features are approximate only.

□ □ □ □ Denotes restricted head height

© ehouse. Unauthorised reproduction prohibited. Drawing ref. dig/8593310/SLU



Period Homes by Simon Miller Office
Weald, 5 High Street, Headcorn, Ashford,
Kent, TN27 9NH

Contact

01622 850888
admin@periodhomesbysimonmiller.co.uk
<https://simonmiller.co.uk/period-homes/>

Agents Note: Whilst every care has been taken to prepare these particulars, they are for guidance purposes only. All measurements are approximate and for general guidance purposes only and whilst every care has been taken to ensure accuracy, they should not be relied upon and potential buyers/tenants are advised to recheck the measurements.

