



Willowmead

Leybourne, West Malling ME19 5RE

- SIMON MILLER & COMPANY SOLD STC PRIOR TO ONLINE MARKETING
- SIMILAR PROPERTIES REQUIRED

Offers In Excess Of £300,000 Freehold



Local Authority
Council Tax Band
EPC Rating

Willowmead, Leybourne, West Malling, ME19

Approximate Area = 618 sq ft / 57.4 sq m
For identification only - Not to scale

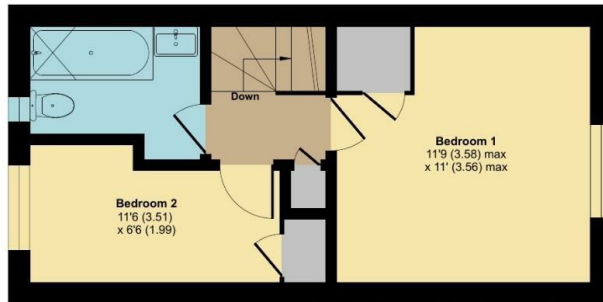

FIRST FLOOR



GROUND FLOOR

Floor plan produced in accordance with RICS Property Measurement 2nd Edition, incorporating International Property Measurement Standards (IPMS2 Residential). © nichecom 2026. Produced for Simon Miller & Company, REF: 1449727



Malling Office
777 London Road, Larkfield, Aylesford,
Kent, ME20 6DE

Contact
01732 875706
larkfieldsales@simonmiller.co.uk
<https://simonmiller.co.uk/>

Agents Note: Whilst every care has been taken to prepare these particulars, they are for guidance purposes only. All measurements are approximate and for general guidance purposes only and whilst every care has been taken to ensure accuracy, they should not be relied upon and potential buyers/tenants are advised to recheck the measurements.