



Maxwell Drive

, Maidstone ME16 0QY

- For Sale By Modern Method Of Auction
- Private Driveway
- Chain Free
- Two Bedroom Bungalow
- Some Cosmetic improvements Required

Auction Guide £300,000 Freehold



Local Authority Maidstone
Borough Council
Council Tax Band D
EPC Rating E



Maxwell Drive, Maidstone, ME16

Approximate Area = 650 sq ft / 60.3 sq m
For identification only - Not to scale

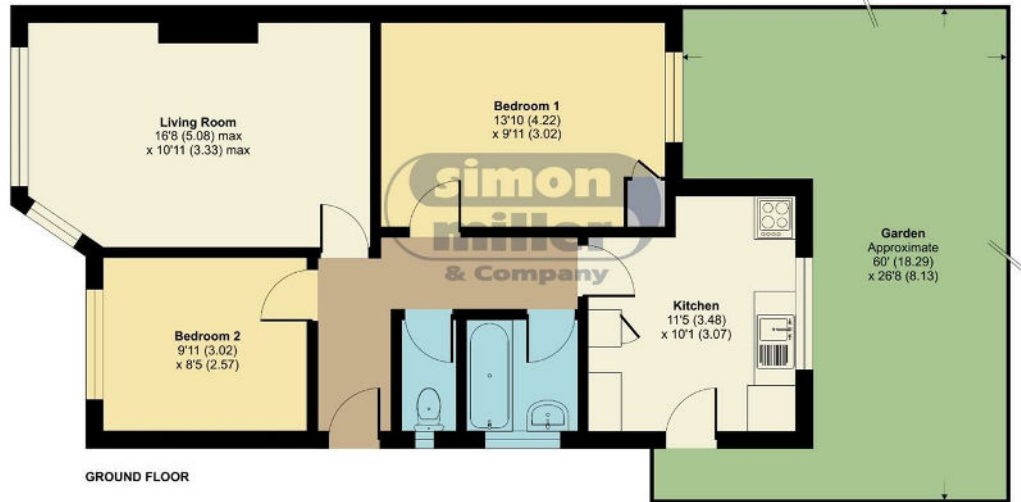

Floor plan produced in accordance with RICS Property Measurement Standards incorporating International Property Measurement Standards (IPMS2 Residential). © richecom 2023. Produced for Simon Miller & Company. REF: 976148

Maidstone & The Weald Office
11 Colman House, Colman Parade, King
Street, Maidstone, Kent, ME14 1DJ

Contact
01622 691255
maidstonesales@simonmiller.co.uk

Agents Note: Whilst every care has been taken to prepare these particulars, they are for guidance purposes only. All measurements are approximate and for general guidance purposes only and whilst every care has been taken to ensure accuracy, they should not be relied upon and potential buyers/tenants are advised to recheck the measurements.

