



Betjeman Close

Larkfield, Aylesford ME20 6TQ

- Newly refurbished property
- Popular Poets Development
 - Private rear garden
- Available immediately!!!
- 2 Double Bedrooms
 - End of Terrace
 - Allocated parking

£1,200 PCM



Local Authority Tonbridge and
Malling Borough Council
Council Tax Band C
EPC Rating

Betjeman Close, Larkfield, Aylesford, ME20

Approximate Area = 578 sq ft / 53.6 sq m
For identification only - Not to scale

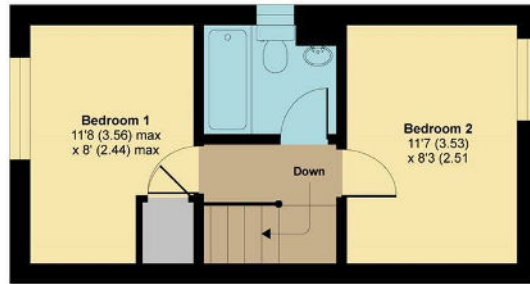

FIRST FLOOR

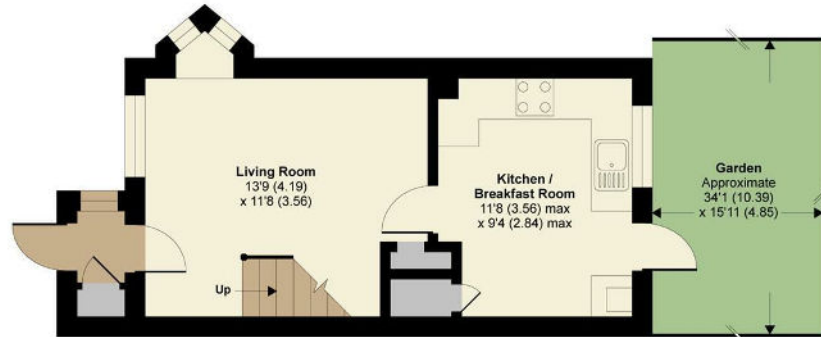

GROUND FLOOR



Floor plan produced in accordance with RICS Property Measurement Standards incorporating International Property Measurement Standards (IPMS2 Residential). ©nichecom 2020. Produced for Simon Miller & Company. REF: 601629

Lettings Office

Lettings Division, 779 London Road,
Larkfield, Aylesford, Kent, ME20 6DE

Contact

01732 875777
lettings@simonmiller.co.uk
<https://simonmiller.co.uk/landlo/services/>

Agents Note: Whilst every care has been taken to prepare these particulars, they are for guidance purposes only. All measurements are approximate and for general guidance purposes only and whilst every care has been taken to ensure accuracy, they should not be relied upon and potential buyers/tenants are advised to recheck the measurements.