

PERIOD HOMES

By Simon Miller



Clare Lane

East Malling, West Malling ME19 6JB

- A Fantastic Grade II Period Home
- Steeped in Local History
- Driveway and Detached Double Garage
- GUIDE PRICE: £550,000-£580,000
- Restored and Improved
- Close to West Malling Village
- Vacant Possession Available

Guide Price £550,000 Freehold

Local Authority
Council Tax Band E
EPC Rating

Denotes restricted
head height



East Malling, West Malling, ME19

Approximate Area = 1592 sq ft / 147.9 sq m (includes garage)
Limited Use Area(s) = 70 sq ft / 6.5 sq m
Total = 1662 sq ft / 154.4 sq m
For identification only - Not to scale

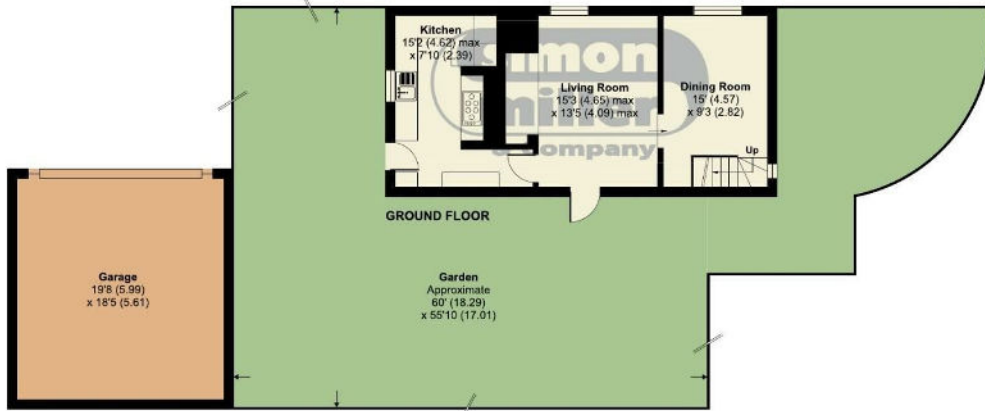
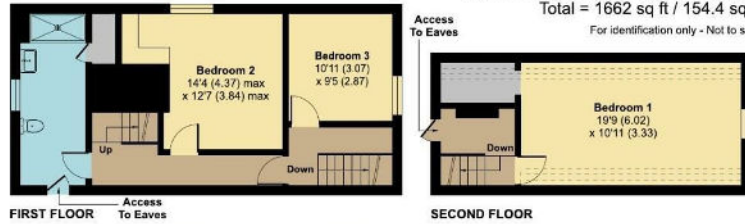

 Floor plan produced in accordance with RICS Property Measurement Standards incorporating International Property Measurement Standards (IPMS2 Residential). © richcom 2023. Produced for Simon Miller & Company. REF: 842583



Period Homes by Simon Miller Office
Weald, 5 High Street, Headcorn, Ashford,
Kent, TN27 9NH

Contact
01622 850888
admin@periodhomesbysimonmiller.co.uk
<https://simonmiller.co.uk/period-homes/>

Agents Note: Whilst every care has been taken to prepare these particulars, they are for guidance purposes only. All measurements are approximate and for general guidance purposes only and whilst every care has been taken to ensure accuracy, they should not be relied upon and potential buyers/tenants are advised to recheck the measurements.