



## Ashford Road

, Maidstone ME14 5DG

- Immaculately Presented Throughout
  - Fantastic Fitted Kitchen
  - Allocated Parking Space
- One Bedroom Ground Floor Apartment
  - High Ceilings
  - Sought After Town Centre Location

**Asking Price £165,000 Leasehold**



Local Authority  
Council Tax Band B  
EPC Rating D



## Ashford Road, ME14

Approximate Area = 462 sq ft / 42.9 sq m  
For identification only - Not to scale

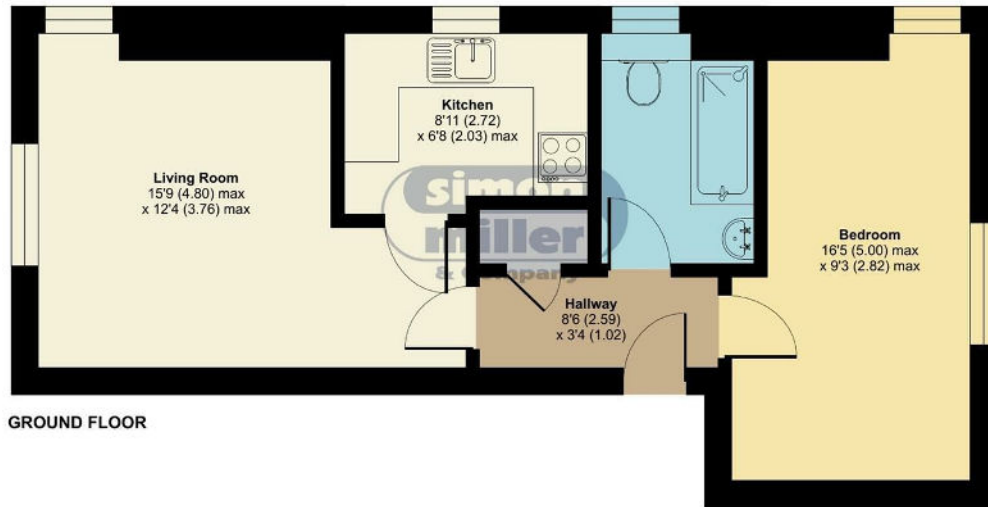

Floor plan produced in accordance with RICS Property Measurement Standards incorporating International Property Measurement Standards (IPMS2 Residential). © nichecom 2023. Produced for Simon Miller & Company. REF: 1004413

**Maidstone & The Weald Office**  
11 Colman House, Colman Parade, King  
Street, Maidstone, Kent, ME14 1DN

**Contact**  
01622 691255  
maidstonesales@simonmiller.co.uk

Agents Note: Whilst every care has been taken to prepare these particulars, they are for guidance purposes only. All measurements are approximate and for general guidance purposes only and whilst every care has been taken to ensure accuracy, they should not be relied upon and potential buyers/tenants are advised to recheck the measurements.

