

PERIOD HOMES

By Simon Miller



Pye Corner, Ulcombe ME17 1EG

- Guide Price £600,000 - £650,000
- Secluded Rural Setting
 - Large Fish Pond
- Luxurious Family Bathroom & En-Suite Shower Room
- Ample Gated Parking
- Beautiful Presented Detached Former Stables
 - Large Mature Plot over ½ Acre
 - Character Features Throughout
 - Modern Fitted Kitchen
 - Unique Semi-Rural Setting

Price Guide £600,000 Freehold

Local Authority
Council Tax Band D
EPC Rating D



Pye Corner, Ulcombe, Maidstone, ME17

Approximate Area = 1508 sq ft / 140 sq m
Limited Use Area(s) = 74 sq ft / 6.8 sq m
Outbuilding = 192 sq ft / 17.8 sq m
Total = 1774 sq ft / 164.6 sq m

For identification only - Not to scale



Denotes restricted
head height

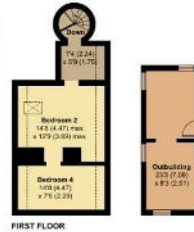

Floor plan produced in accordance with RICS Property Measurement Standards incorporating International Property Measurement Standards (IPMS2 Residential). © richcom 2023. Produced for Simon Miller & Company. REF: 1022974

Period Homes by Simon Miller Office
Weald, 5 High Street, Headcorn, Ashford,
Kent, TN27 9NH

Contact

01622 850888
admin@periodhomesbysimonmiller.co.uk
<https://simonmiller.co.uk/period-homes/>

Agents Note: Whilst every care has been taken to prepare these particulars, they are for guidance purposes only. All measurements are approximate and for general guidance purposes only and whilst every care has been taken to ensure accuracy, they should not be relied upon and potential buyers/tenants are advised to recheck the measurements.

