



Cottenham Close

East Malling, West Malling ME19 6BZ

- CHAIN FREE
- Master Bedroom With En-Suite
- Open Plan 'L' Shaped Kitchen / Diner
- Large Driveway And Garage
- Two Double Bedrooms
- SOUTH Facing Rear Garden

Asking Price £335,000 Freehold

Local Authority
Council Tax Band D
EPC Rating D

Cottenham Close, East Malling, West Malling, ME19

Approximate Area = 912 sq ft / 84.7 sq m
Limited Use Area(s) = 3 sq ft / 0.2 sq m
Garage = 264 sq ft / 24.5 sq m
Total = 1179 sq ft / 109.4 sq m

For identification only - Not to scale

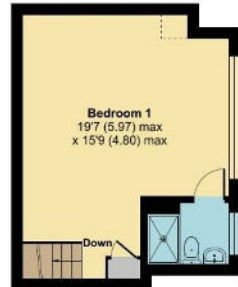

Denotes restricted head height



FIRST FLOOR

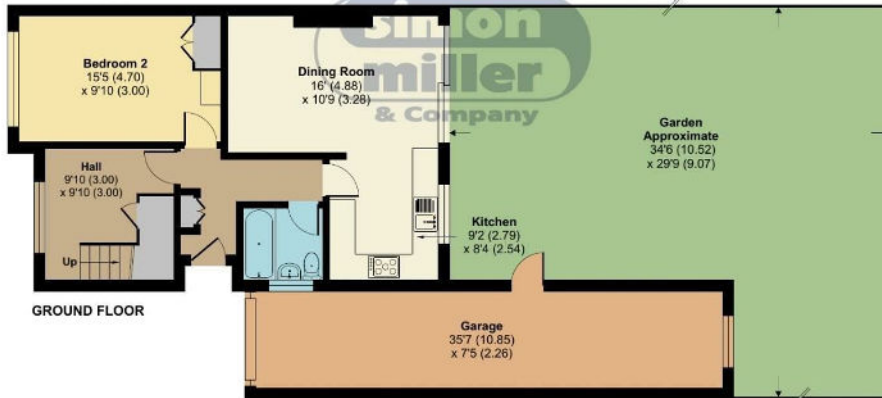

GROUND FLOOR



Floor plan produced in accordance with RICS Property Measurement Standards incorporating International Property Measurement Standards (IPMS2 Residential). © richcom 2023. Produced for Simon Miller & Company. REF: 1041706



Malling Office
777 London Road, Larkfield, Aylesford,
Kent, ME20 6DE

Contact
01732 875706
larkfieldsales@simonmiller.co.uk
<https://simonmiller.co.uk/>

Agents Note: Whilst every care has been taken to prepare these particulars, they are for guidance purposes only. All measurements are approximate and for general guidance purposes only and whilst every care has been taken to ensure accuracy, they should not be relied upon and potential buyers/tenants are advised to recheck the measurements.