



## Kingfisher Meadow

, Maidstone ME16 8RB

- GUIDE PRICE £150,000 - £160,000
  - One Double Bedroom
  - 15ft X 12ft Sitting/Dining Room
  - Allocated Parking Space
  - Entry Phone System
- No Forward Chain
- Modern Fitted Kitchen
- Sit Out large Balcony
- Ideal Investment Or First Time Buy
- Close To Mainline Stations

**Guide Price £150,000 Leasehold**

Local Authority  
Council Tax Band C  
EPC Rating C

## Kingfisher Meadow, Maidstone, ME16

Approximate Area = 402 sq ft / 37.3 sq m  
For identification only - Not to scale

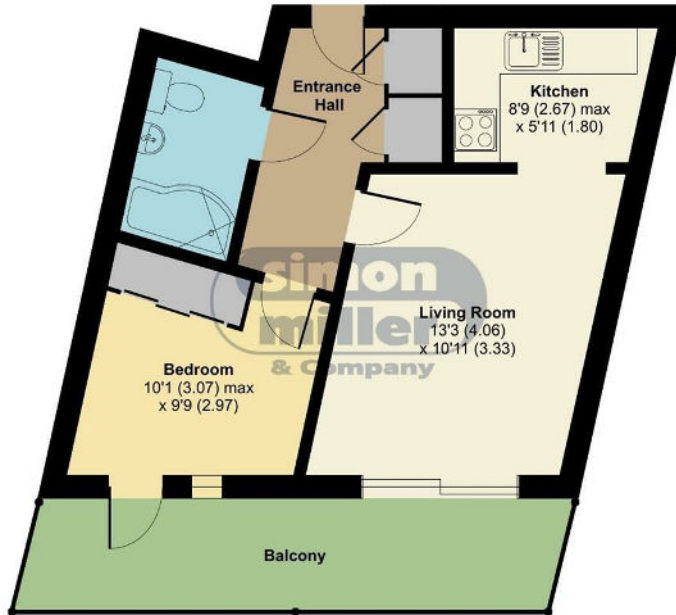

THIRD FLOOR



Floor plan produced in accordance with RICS Property Measurement Standards incorporating International Property Measurement Standards (IPMS2 Residential). © richecom 2023. Produced for Simon Miller & Company. REF: 1050742

### Maidstone & The Weald Office

11 Colman House, Colman Parade, King  
Street, Maidstone, Kent, ME14 1DJ

### Contact

01622 691255  
maidstonesales@simonmiller.co.uk

Agents Note: Whilst every care has been taken to prepare these particulars, they are for guidance purposes only. All measurements are approximate and for general guidance purposes only and whilst every care has been taken to ensure accuracy, they should not be relied upon and potential buyers/tenants are advised to recheck the measurements.

