



## Chestnut Close

Kings Hill, West Malling ME19 4FP

- A Bryant Designed Four Bedroom Detached Family Home
- Detached Double Garage with Extra Parking/Driveway
- Front and Rear Gardens
- GUIDE PRICE: £650,000-£675,000
- Situated on the Popular PHASE 1 part of Kings Hill Home
- Corner Plot Position
- Close to local Amenities

**Guide Price £650,000 Freehold**



Local Authority  
Council Tax Band G  
EPC Rating C



## Chestnut Close, Kings Hill, West Malling, ME19

Approximate Area = 1394 sq ft / 129.5 sq m

Garage = 291 sq ft / 27 sq m

Total = 1685 sq ft / 156.5 sq m

For identification only - Not to scale

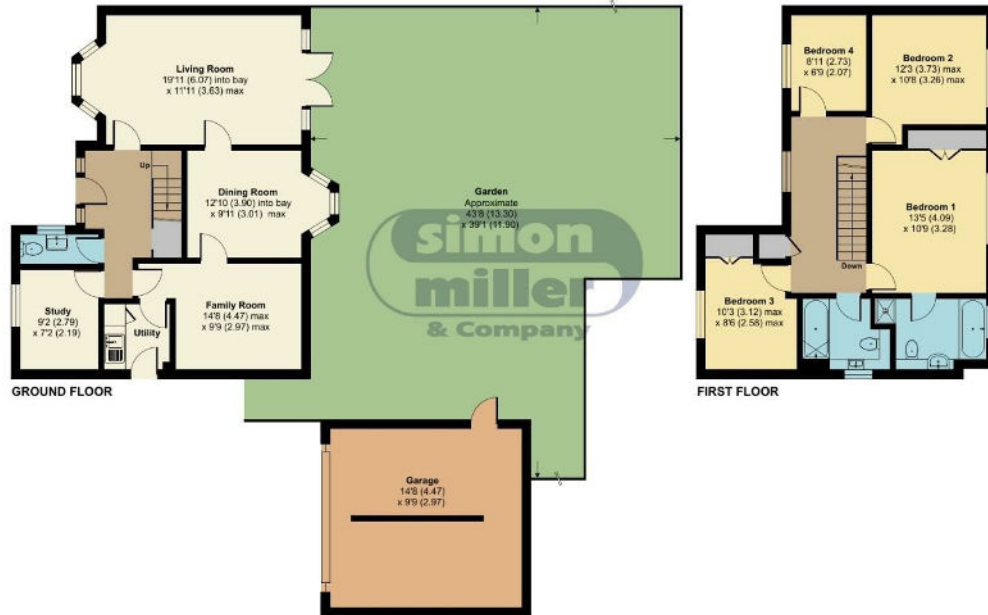

Floor plan produced in accordance with RICS Property Measurement Standards incorporating International Property Measurement Standards (IPMS2 Residential). © richcom 2024. Produced for Simon Miller & Company. REF: 1082728



### Malling Office

777 London Road, Larkfield, Aylesford,  
Kent, ME20 6DE

### Contact

01732 875706  
larkfieldsales@simonmiller.co.uk  
<https://simonmiller.co.uk/>

Agents Note: Whilst every care has been taken to prepare these particulars, they are for guidance purposes only. All measurements are approximate and for general guidance purposes only and whilst every care has been taken to ensure accuracy, they should not be relied upon and potential buyers/tenants are advised to recheck the measurements.