



Marlowe Road

Larkfield, Aylesford ME20 6TE

- GUIDE PRICE £300,000 - £320,000
- Modern And Contemporary Throughout
- Kitchen And Breakfast Bar With Underfloor Heating
 - SOUTH Facing Rear Garden
 - Recently Fitted Boiler
- Garage En Bloc
- Conservatory
- Open Plan Living
- Outbuilding With Power

Price Guide £300,000 Freehold

Local Authority
Council Tax Band C
EPC Rating C

Marlowe Road, Larkfield, Aylesford, ME20

Approximate Area = 689 sq ft / 64 sq m
Garage = 144 sq ft / 13.4 sq m
Total = 833 sq ft / 77.4 sq m
For identification only - Not to scale

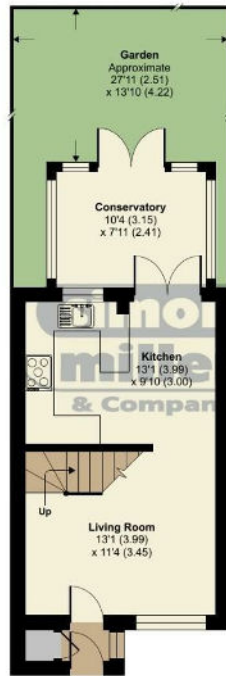

GROUND FLOOR

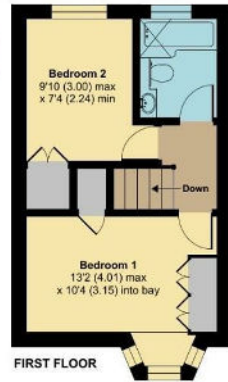

FIRST FLOOR

 Floor plan produced in accordance with RICS Property Measurement Standards incorporating International Property Measurement Standards (IPMS2 Residential). © richcom 2024. Produced for Simon Miller & Company. REF: 1101450



Mailing Office

777 London Road, Larkfield, Aylesford,
Kent, ME20 6DE

Contact

01732 875706
larkfieldsales@simonmiller.co.uk
<https://simonmiller.co.uk/>

Agents Note: Whilst every care has been taken to prepare these particulars, they are for guidance purposes only. All measurements are approximate and for general guidance purposes only and whilst every care has been taken to ensure accuracy, they should not be relied upon and potential buyers/tenants are advised to recheck the measurements.