



## Lunsford Lane

Larkfield, Aylesford ME20 6JA

- A 3/4 Bedroom Detached Chalet Bungalow
- Walking Distance to Pleasant Walks around Leybourne Lakes
- Situated in a No Through Road
- Parking/Driveway to Front
- Gardens to Rear and Side
- No Onward Chain

**O.I.R.O £425,000 Freehold**



Local Authority  
Council Tax Band E  
EPC Rating C

## Lunsford Lane, Larkfield, Aylesford, ME20

Approximate Area = 1023 sq ft / 95 sq m  
Limited Use Area(s) = 111 sq ft / 10.3 sq m  
Total = 1134 sq ft / 105.3 sq m

For identification only - Not to scale

Denotes restricted  
head height

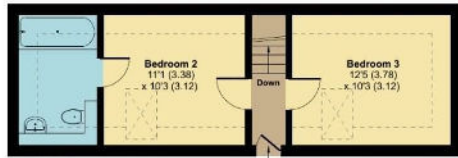

FIRST FLOOR



GROUND FLOOR



Floor plan produced in accordance with RICS Property Measurement Standards incorporating International Property Measurement Standards (IPMS2 Residential). © richcom 2024. Produced for Simon Miller & Company. REF: 1102333



**Malling Office**  
777 London Road, Larkfield, Aylesford,  
Kent, ME20 6DE

**Contact**  
01732 875706  
larkfieldsales@simonmiller.co.uk  
<https://simonmiller.co.uk/>

Agents Note: Whilst every care has been taken to prepare these particulars, they are for guidance purposes only. All measurements are approximate and for general guidance purposes only and whilst every care has been taken to ensure accuracy, they should not be relied upon and potential buyers/tenants are advised to recheck the measurements.